



Read the instruction manual and store it for future reference

*USER GUIDE*

**ELECTRICAL LOADING SYSTEM FOR STRETCHER SUPPORT**

Review 01/20



# INDEX

01	INTRODUCTION	
01.1	Using this manual .....	05
01.2	Meaning of Symbols .....	06
01.3	Serving request.....	06
01.4	Demolition .....	06
01.5	Technical data sheet.....	07
02	WARNINGS	
02.1	General warnings .....	08
02.2	Specific warnings .....	10
02.3	Contradictions and side effects.....	11
02.4	Physical requirements of the operators.....	11
03	INSTALATION	
03.1	Transporting and unpacking.....	12
03.2	Device's preparation .....	13
03.3	Installing the device.....	14
04	ELECTRICAL CIRCUIT DIAGRAM	
04.1	Electric diagram .....	21
05	OPERATING	
05.1	General elements WINCH.....	22
	05.1.1 Protective cover.....	23
	05.1.2 Fastening system with belt .....	23
	05.1.3 Hand control.....	23
06	MOUNTING AND COMPONENTS	
06.1	Main exploded view of WINCH .....	24
06.2	Bill of materials main exploded view.....	25
06.1	Exploded view of electrical components, cover and screws.....	26
06.2	Bill of materials of exploded view of electrical components, cover and screws.....	27
07	TROUBLESHOOTING.....	29
08	GENERAL MAINTENANCE.....	30
09	LEGAL NOTICES.....	31
10	PRODUCT WARRANTY.....	33
11	TRAINING REGISTER .....	34
12	MAINTENANCE REGISTER.....	35



# 01 INTRODUCTION

## 01.1 Manual usage

This manual provides using and maintenance instructions of the product, as well as the way of fixing minor faults that could appear.

It is recommended before the operation of the product to read carefully this manual in order to avoid damages caused by a misuse.

Do not lose this document, it should be accessible to any doubt that could appear by medical personnel.

Remember that a good use and maintenance are necessary for the proper operation of the product.

Each product incorporates an identification sticker with the serial number and the model. Keep these numbers so that they can be indicated to the dealer if necessary.

# 01 INTRODUCTION

## 01.2 Meaning of Symbols



General warning of possible injuries



Read the user manual



Certificate of Quality Management System



IQNet Certificate



This product is compliant with the specifications of European Union



QR Code (Access Online Web)



Unlocked



Locked

## 01.3 Serving request

For information of the correct interpretation of the instruction manual, the use, maintenance, installation and restoration of the product, please contact Promeba customer service T. 93 837 12 00, Fax 93082061008, email [promeba@promeba.com](mailto:promeba@promeba.com) or write to PROMEBA, S.L. - Ctra C-16 Km 59.5 · 08650 Sallent (Barcelona) · SPAIN.

## 01.4 Demolition

When the devices are no longer suitable for use, if they have not been contaminated by any particular agent, they can be disposed of as normal solid waste, otherwise, follow the current demolition regulations.

# 01 INTRODUCTION

## 01.5 Technical data sheet

### MEASURES AND FEATURES //

LENGTH	262 mm	MAX. LOAD	250 Kg
WIDTH	183 mm	OPERATORS REQUIRED	1
HEIGHT	337 mm	INPUT VOLTAGE	12 V
WEIGHT	8,2 Kg	MAXIMUM WORK INCLINATION	20 %

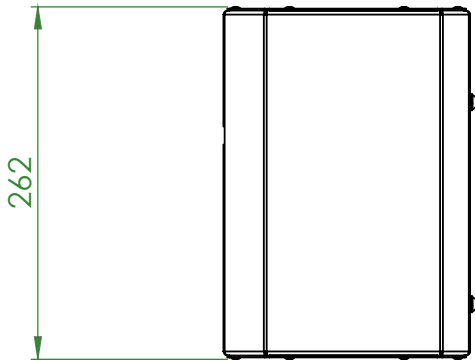
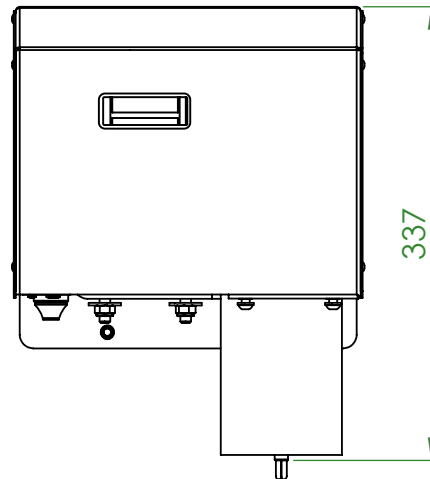
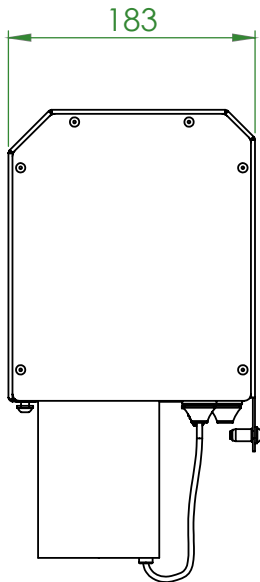

## 02 WARNINGS

### 02.1 General warnings

- The product has to be used by trained personnel only, who must have specific training for the use of this product and not for similar products.
- Training routines must be registered on a special register in which the names of the persons trained, their trainers, the place and the date of the training are indicated. This registry, which will certify the eligibility of the operators to use the Promeba product, must be retained for a period of 10 years after the elimination of the product. This record will be made available to the competent authorities and/or the manufacturer if requested.
- **Promeba, S.L.** is always at your disposal to plan the product formations.
- Before carrying out any type of operation on the product (training, installation, use), the operator must carefully read the attached instructions, paying special attention to the correct safety precautions and the procedures that must be followed for the installation and for the correct use.
- If you have any questions regarding the interpretation of these instructions, please contact **Promeba, S.L.** for any kind of clarification.
- If the instructions belong to another device and not to the purchased device, inform the manufacturer immediately and avoid the use of this device.
- Before each use of the device, the perfect functioning of the device must be verified, as specified in the instruction manual. In case of detecting damages or anomalies that could influence in some way the correct functioning or safety of the device, the patient or the operator; the device must be immediately removed from service and you must contact the manufacturer.
- In case of detecting any failure or incorrect functioning of the device, it must be replaced immediately by a similar device in order to be able to guarantee the rescue procedures without any interruption. Regularly check the product, carry out the prescribed maintenance and respect the service life, as indicated by the manufacturer in this manual.
- Do not allow people without training to help during the use of the device, because they could cause damage to the patient or to themselves.
- It is totally forbidden to use the device in any other way than the one described in this manual.
- Do not alter or modify this device in any way; any modification of this device could cause malfunctions and injuries to the patient and/or rescue personnel.
- The device must not be manipulated in any way (modification, adjustment, replacement). In such cases all responsibility will be denied for any malfunctions or injuries caused by this device. In addition, CE certification and product warranty will be considered void.
- All those who modify or have modified, prepared or have prepared medical devices in such way that they no longer serve the purpose for which they were designed, or no longer provide the desired service, must satisfy the valid conditions for the introduction of these in the market.



## 02 WARNINGS

- Register and store with these instructions: lot number, place and date of purchase, first date of use, date of checks, name of operators and any other comments.
- Be sure to take all necessary precautions to avoid the dangers that may arise as a result of contact with blood or body fluids.
- Do not store the device under heavy objects that could cause structural damage.
- Store in a cool, dry, dark place and do not expose the device directly to the sun.
- Store and transport the product in its original packaging.
- The product must not be exposed or come into contact with any source of combustion or flammable agents.
- When the product is being used, the assistance of qualified personnel must be guaranteed.
- Attention: laboratory tests, post-production tests, instruction manuals cannot always consider all possible scenarios of use. This means that, in some cases, the performance of the product could have significantly different from results to date obtained. Instructions are continually updated and are under the strict supervision of fully qualified personnel with the appropriate technical formation.
- In addition, both public and private services are obliged to inform the manufacturer of any measures that should be adopted in order to take the necessary steps to guarantee the safety and health of patients and users of any medical device.
- As a distributor or end users of products manufactured and/or marketed by **Promebea, S.L.**, it is strictly required that you have a basic knowledge of any legal requirement that applies to the supplied devices, for the countries in which they will end up (including laws and norms regarding technical specifications and/or safety requirements) and, therefore, it is also strictly required to have the necessary knowledge to guarantee all aspects related to the total conformity of the products to the regulations in the corresponding territory.
- Promptly notify **Promebea, S.L.** with respect to any revision that the manufacturer must carry out in order to guarantee the conformity of the product to the legal specifications of the territory (including those resulting from rules and/or norms of other nature).
- Act, with due care and diligence, and help ensure compliance to general security requirements of all devices marketed in the territory, providing end users with all the information necessary to perform periodic checks of their devices, as specified in the instruction manual.
- Actively contribute to the security controls of the products sold, communicating any relevant risk analysis information both the manufacturer and to competent authorities so that the necessary measures can be taken promptly.
- You are aware that, in case of it does not comply with the above mentioned requirements, you will be considered totally responsible for all damages that may occur. Therefore we expressly disclaim any responsibility and/or liability for your non-compliance with the present regulatory provisions.

## 02 WARNINGS

### 02.2 Specific warnings

- Establish a maintenance program and periodic tests, identifying a reference employee. The person entrusted with the ordinary maintenance of the device must guarantee the basic requirements foreseen by the manufacturer in the user manual.
- Use only accessories/spare parts original or approved by Promeba, S.L., in order to carry out any operation without altering or modifying the device; otherwise we assume no responsibility for the correct operation or damage resulting from the device to the patient or the operator and the warranty will be considered void, in accordance with the compliance of the Medical Device Directive 93/42/EEC.
- Always respect the maximum load capacity of the device, as indicated in this manual. The maximum load capacity means the total weight distributed according to the human anatomy. When determining the load of the total weight on the product, the operator should consider the patient's weight, equipment and accessories. In addition, the operator must consider that the overall dimensions of the patient do not reduce the functionality of the device.
- Never leave the patient without any assistance in the device, because he could be injured.
- Before each use, check the integrity of the belts and their hooks, as specified in the manual. In case of malfunction or any damage that may compromise the function and safety of the device, the patient or the operator, it is necessary to replace the belts.

## 02 WARNINGS

### 02.3 Contradictions and side effects

The use of this device, if used as described in this manual, does not present any contradiction or collateral effect.

### 02.4 Physical requirements of the operators

This product is intended only for use by specialized operators. The rescue team must have, at least, the following requirements:

- Physical capacity to be able to operate the device.
- Being able to grasp the stretcher firmly with both hands.
- Strong back, arms and legs to lift, push and pull the stretcher.
- Have a good muscular coordination.



The capabilities of the various operators must be considered before determining the function they will have in the operation of the device.

## 03 INSTALLATION

### 03.1 Transport and unpacking

First remove the packaging carefully so as not to damage the device.

#### 1. Transport

Before transporting the product, make sure it is properly packed, making sure there are no risks of crashes, bumps or falls during transport.

Keep the original packaging for use in case of any other transport and storage. Damage to the product caused during transportation and handling is not covered by the warranty. Repairs or replacement of damaged parts are the responsibility of the customer. The device should be stored in a dry and cool place, away from direct sunlight. It must not come into contact with chemical substances or agents that may cause damage and reduce safety features.

Durante el almacenamiento, no coloque materiales pesados sobre el dispositivo. El producto no debe considerarse ni utilizarse como estante para ningún tipo de material.

During storage, do not place heavy materials on the device. The product must not be considered or used as a shelf for any type of material.

- Always fix the load, if it is necessary stack. you should follow the diagram shown.
- Transport the level load and following all the precepts and regulations regarding the transport of loads.

#### 2. Unpacking

- Put the box on a flat and stable surface, open the seal carefully not to damage inside.
- Remove the product from the inside of the case as shown in the chart below.

Each product has been thoroughly inspected when leaving the factory. To ensure that the transport has not deteriorated it, please inspect the exterior and interior carefully, and in the event of any damage, contact the installer immediately.

## 03 INSTALLATION

### 03.2 Device's preparation

On receipt of the product it is advised:

- Remove the packaging and distribute the material such that all components are visible.
- Verify that all components / parts in the attached list are present.

The appliance must be checked before each use in order to detect any malfunction and / or damage caused by transport and / or storage. In particular, check:

- General functionality of the device.
- Cleaning the device (remember that lack of cleanliness can cause the risk of cross-infection).
- Absence of cuts, holes, rips in the structure, including belt.
- Correct fixing of all nuts, bolts and nuts.
- Correct fixing of the belt.
- Correct attachment of the belt.
- State of use (moving parts, belt and covers)
- Integrity of belt and covers.
- Integrity of the components.

If the above conditions are met, the device can be considered ready for use; Otherwise, you must immediately remove the device from the service and contact the manufacturer.

# 03 INSTALLATION

## 03.3 Installing the device

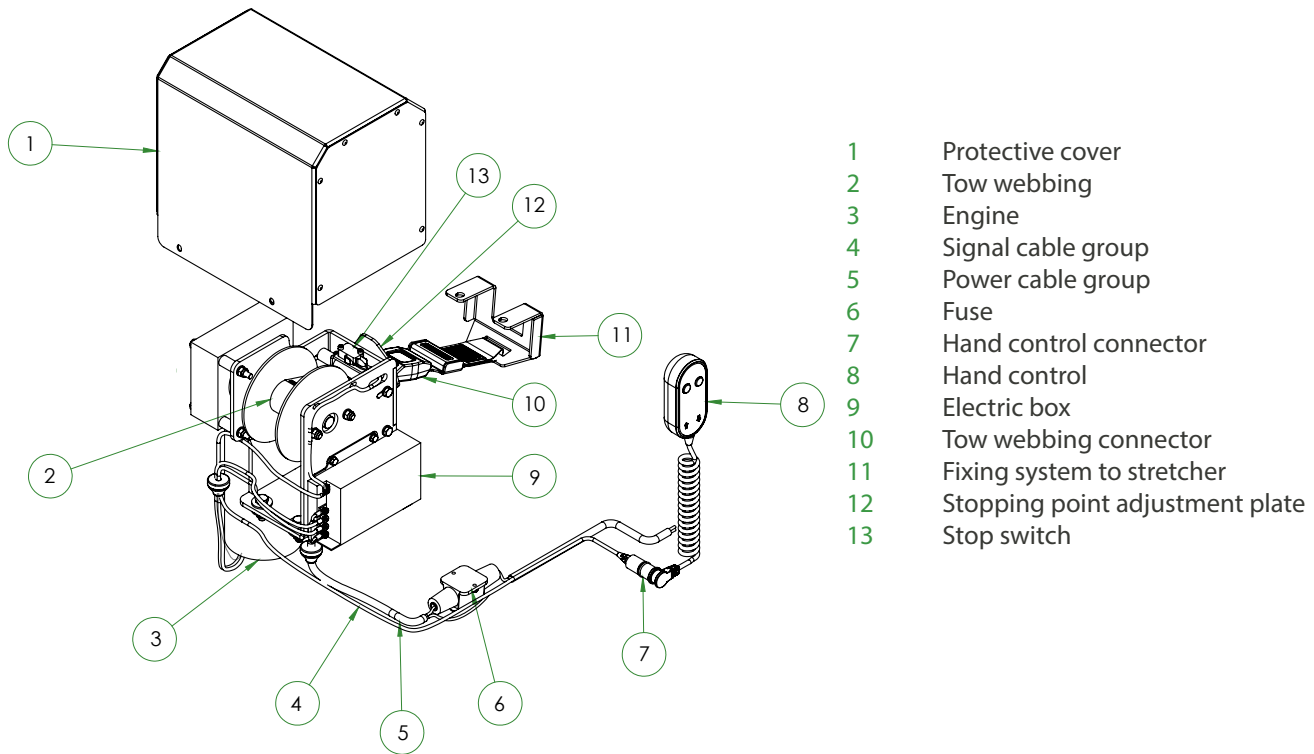

### Winch installation

#### Scenario 1: Winch Kit for Promeba bench PB-410.

It is necessary to acquire the back reinforcement PA4900-00072.

For the installation of the reinforcement on the bench it has to be followed the procedure explained below:

- 1 - Unscrew the hooks from the back of the bench, which act as third fixation point of the stretcher.
- 2 - Allocate the reinforcement as shown in the figure on the right.
- 3 - Introduce the hooks on both sides.
- 4 - Screw the six screws on the three gaps located respectively on each side.
- 5 - Screw the union reinforcements on the lower part of the bench.
- 6 - Ensure that all screws are correctly screwed.

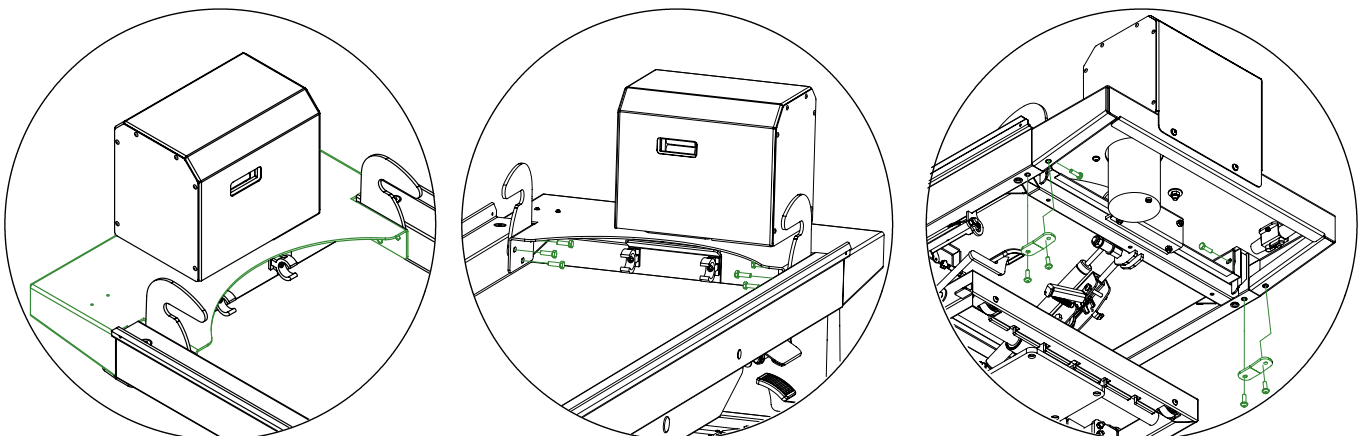

# 03 INSTALATION

## Scenario 2: Winch Kit for NON-Promeba bench

For the installation of the winch on a non-Promeba bench is necessary to perform modifications, indicated in the following drawing, on the reinforcement where the winch will be placed.

(For the manufacturing of the reinforcement it is recommended to use 3mm steel sheet)

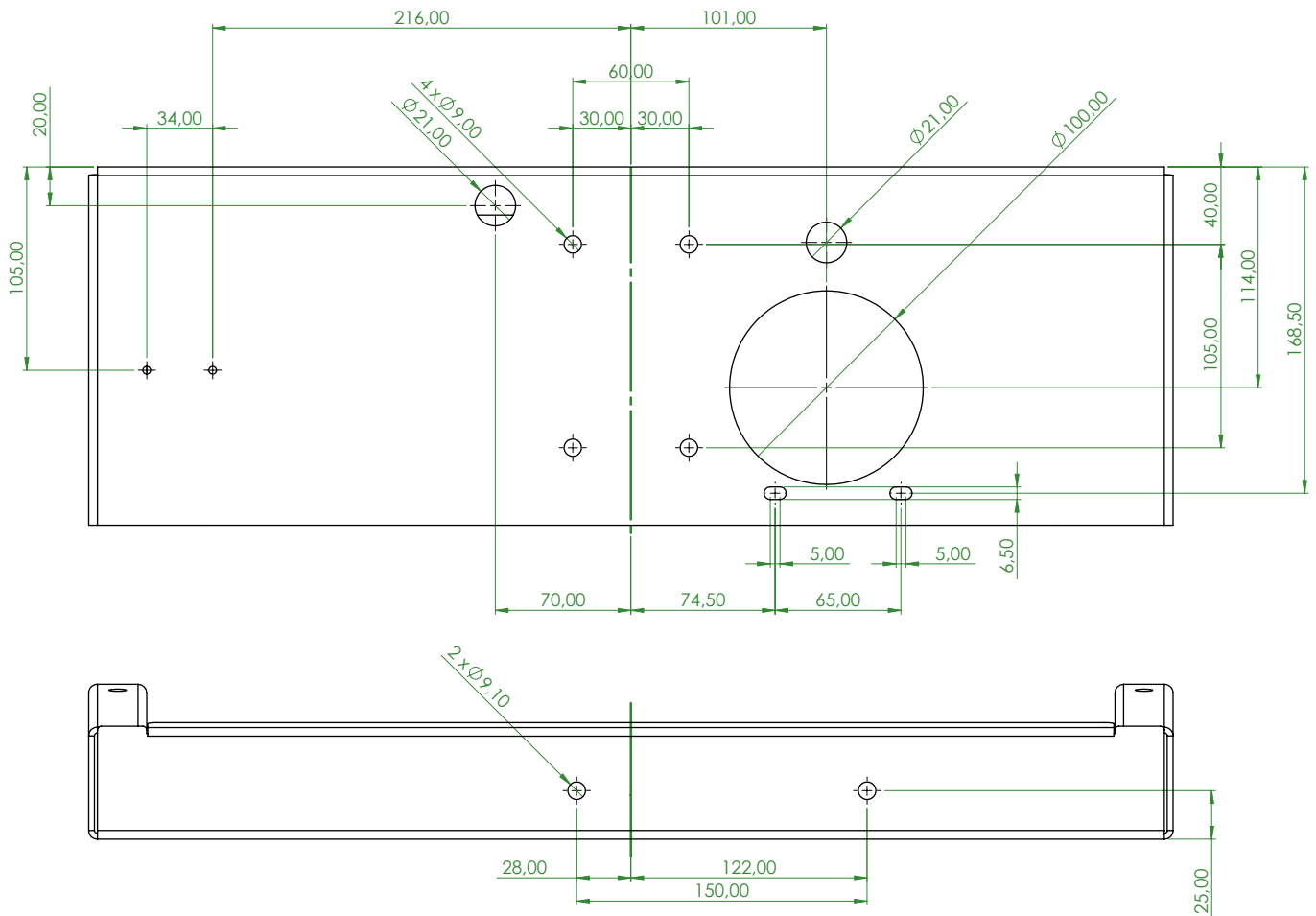

To install the winch on the reinforcement use the modifications performed, and follow these steps:

- 1 - Screw the fuse.
- 2 - Introduce both cable grommets on the holes of  $\varnothing 21\text{mm}$
- 3 - Install the rivet nuts on the holes of the lateral of the support

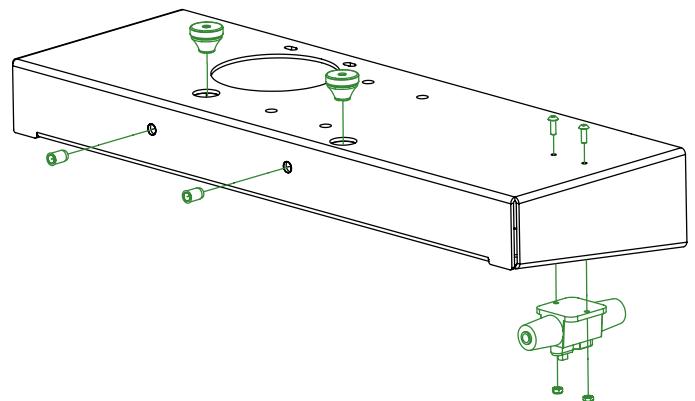

## 03 INSTALLATION

4 - Screw the winch assembly on the four central holes.

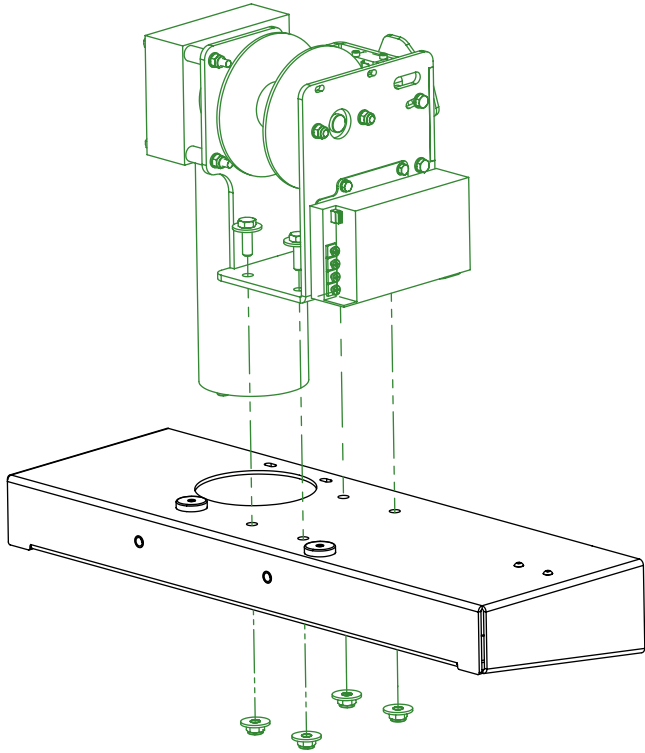

5 - Screw the protective cover of the winch with the lateral holes of the support and the gaps of the top.

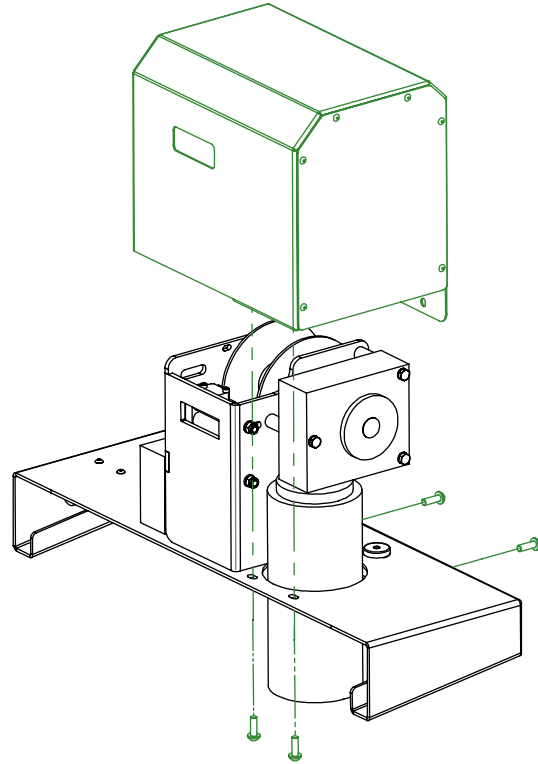

### Installation of the fixing system on the stretcher

#### Scenario 1: Promeba stretcher

- 1 - Remove the two caps found in the central part of the back profile of the stretcher.
- 2 - Unscrew the two screws which hold the brace.
- 3 - Place the fixation support of the belt as indicated in the figure below.
- 4 - Screw the support together with the brace.

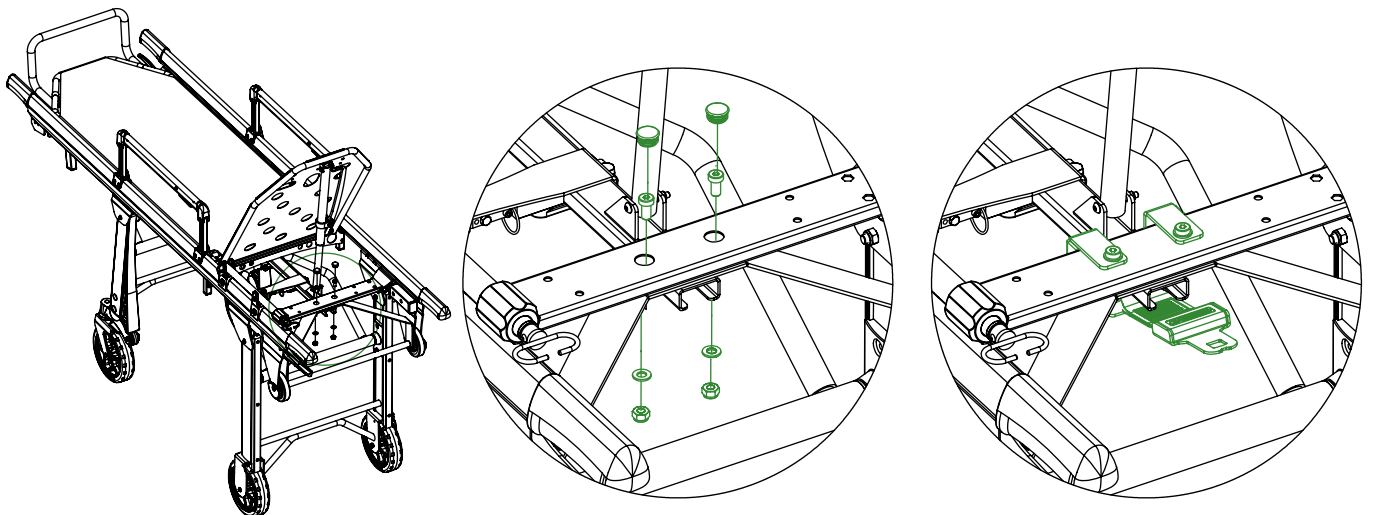



# 03 INSTALLATION

## Scenario 2: Stretcher NON-Promeba

For the installation in a NON-Promeba stretcher it will be necessary to perform the modification indicated in the drawing on the right to the stretcher to be used with the winch.  
Afterwards, screw the support as indicated on the figures of scenario 1.

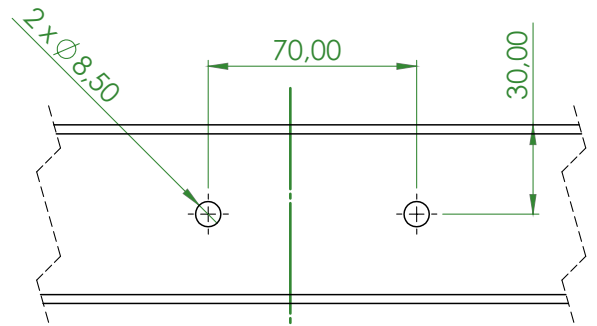

### Engine connection

- 1 - Introduce engine cables through the cable grommet near the engine. Connect the cables on the two central positions of the electric box:
  - 2 - Red cable on the upper position.
  - 3 - Black cable on the lower position.
- \*Use the yellow terminals to connect the cables to the electric box. It is recommended to use some kind of adhesive after connection, to ensure these doesn't move with usage.

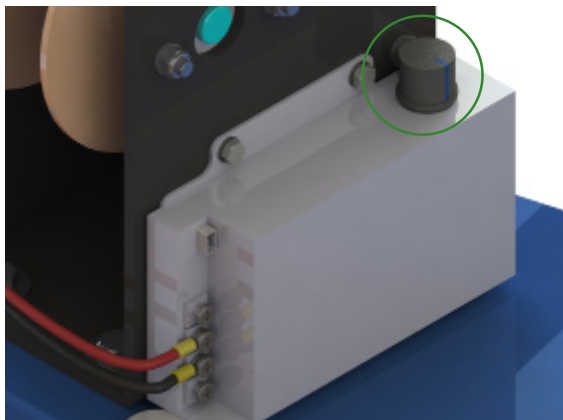
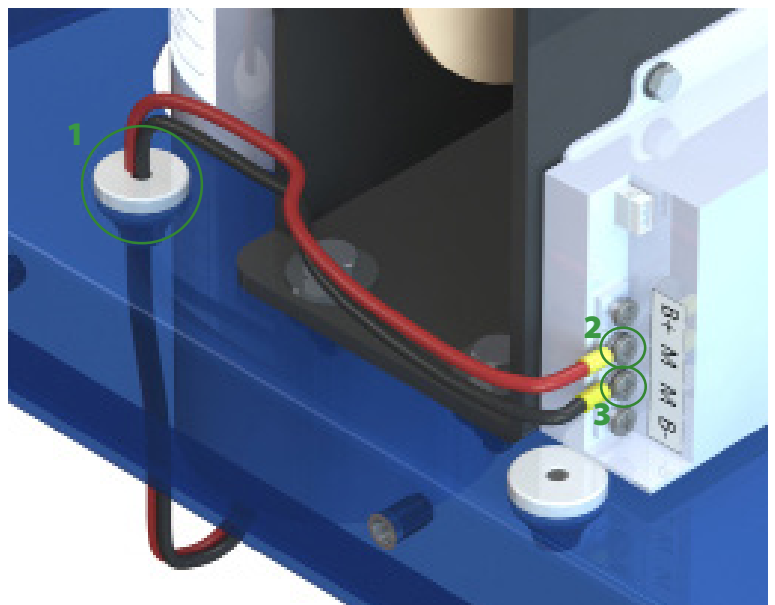

On the upper part of the electric box there is the power regulator. The winch is delivered with the regulator configured to provide the maximum speed. It is recommend to maintain the default setting.

### Connection of signal cable

- 1 - Introduce the signal cable through the cable grommet on the front left part of the bench, as shown on the image.
- 2 - Drive the cable until the back part of the bench through the lateral profile.

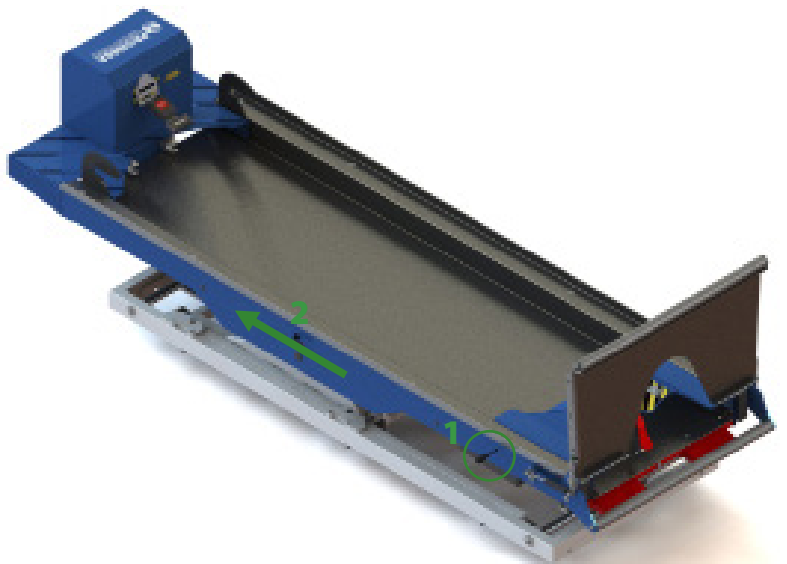

## 03 INSTALATION

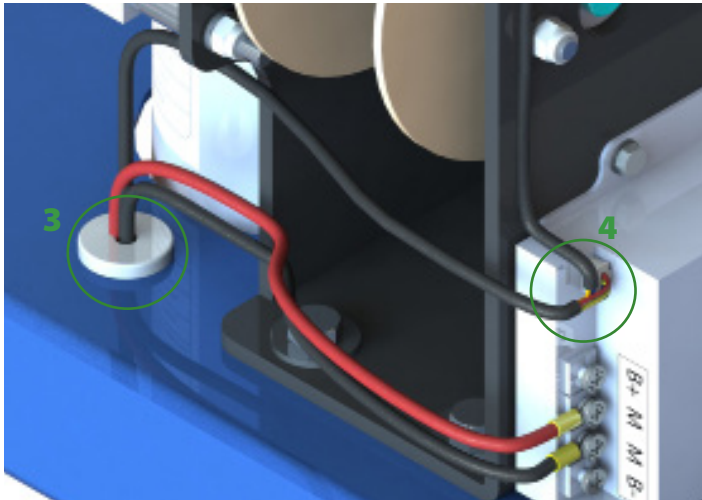

3 - Pass the cable through the cable grommet near to the engine.

4 - Connect the plug of the cable on the free socket remaining in the electric box.

5 - Drive up the cable through the lateral wall of the winch support and clamp it using the gaps of the upper part.

6 - Drive the cable into the big gap of the support.

7 - Connect both terminals of the cable to the microswitch. It has to be connected to the NO terminal (Normally Open).

8 - Connect the hand control to the socket going out on the front part of the bench.

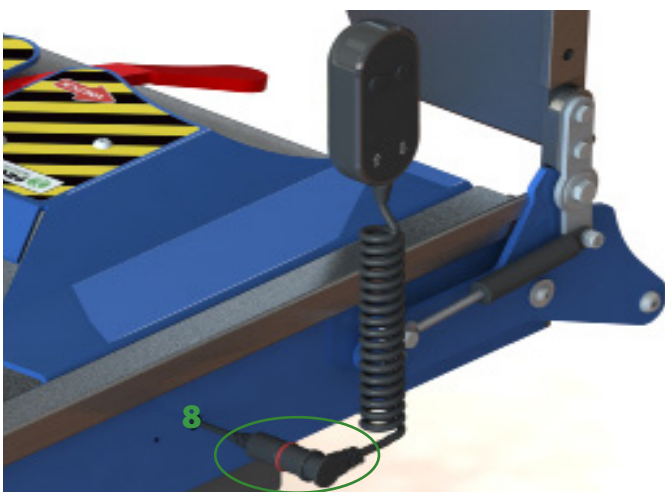
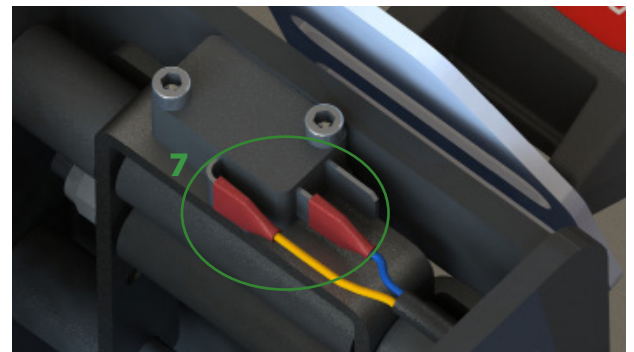
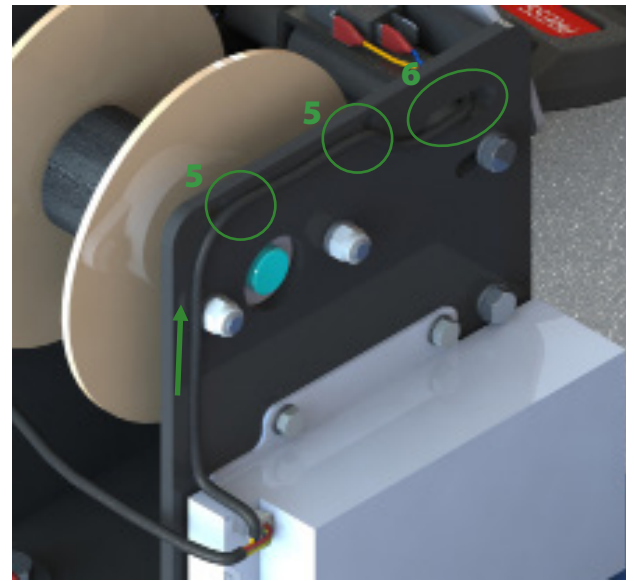

## 03 INSTALLATION

### Connection of power cables group

1 - Introduce the power hose through the cable grommet of the left central side of the bench, as shown in the image. (Path recommended by Prome-ba, it can be changed considering customer preferences)

2 - Drive the hose until the back part of the bench through the lateral profile.

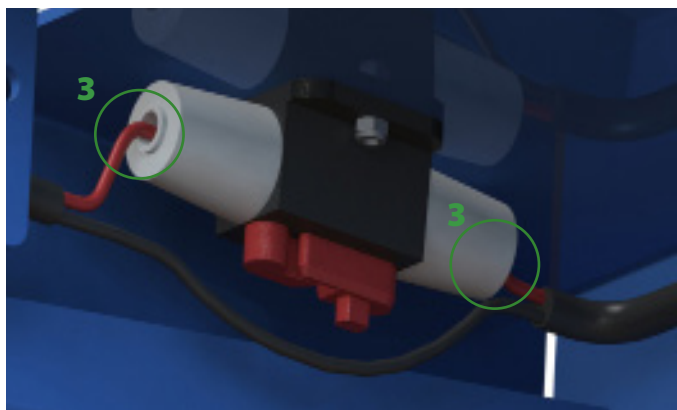
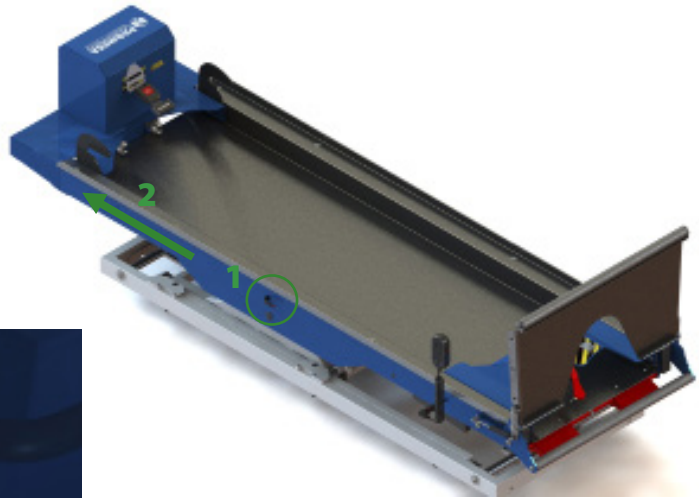

3 - Connect the terminals of the red cable to both sides of the fuse.

4 - Introduce power hose through the cable grommet near the electric box.

Connect both cable to the electric box on the two endpoint positions:

5 - Red cable on the upper position, where is indicated B+.

6 - Black cable on the lower position, where is indicated B-

\*Use the yellow terminals to connect the cables to the electric box. It is recommended to use some kind of adhesive after connection, to ensure these doesn't move with usage.

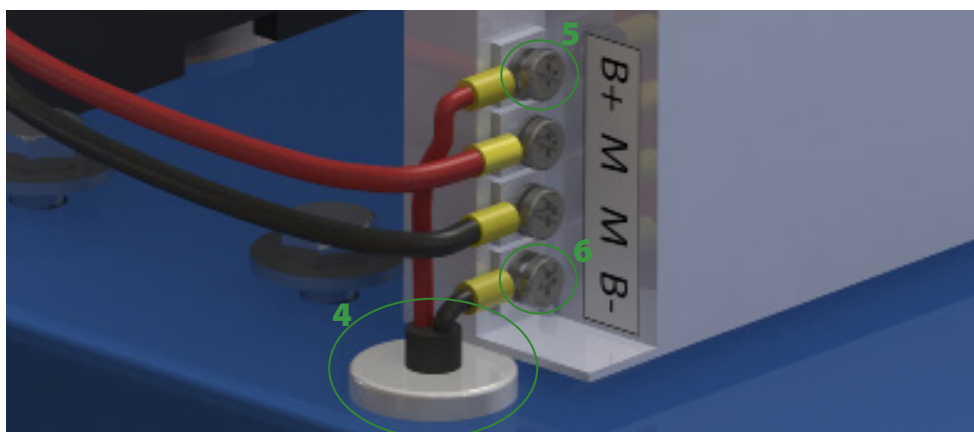

### Adjustment of the stopping point

1 - Unscrew the lateral screws.

2 - Move the plate to the desired position.

3 - Tighten the belt.

4- Screw again the screws, adding screw fixing adhesive to avoid screw loosen with usage.





# 04 ELECTRICAL CIRCUIT DIAGRAM

## 04.1 Electric diagram

Power cable group:

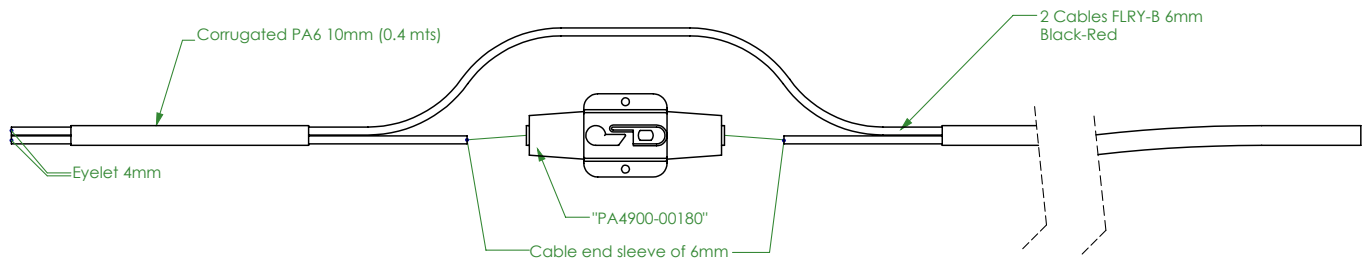

Signal cable group:

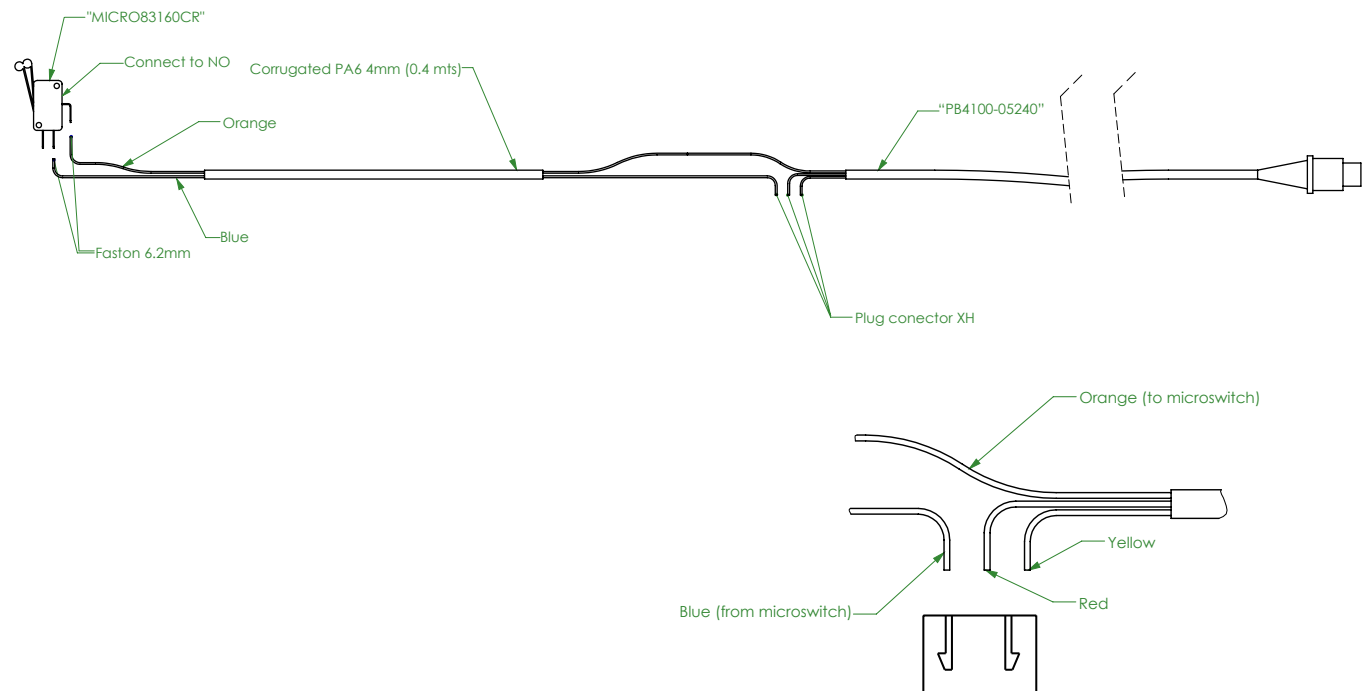

## 05 OPERATING

### 05.1 General elements WINCH

1. Protective cover
2. Fastening system with belt
3. Hand control

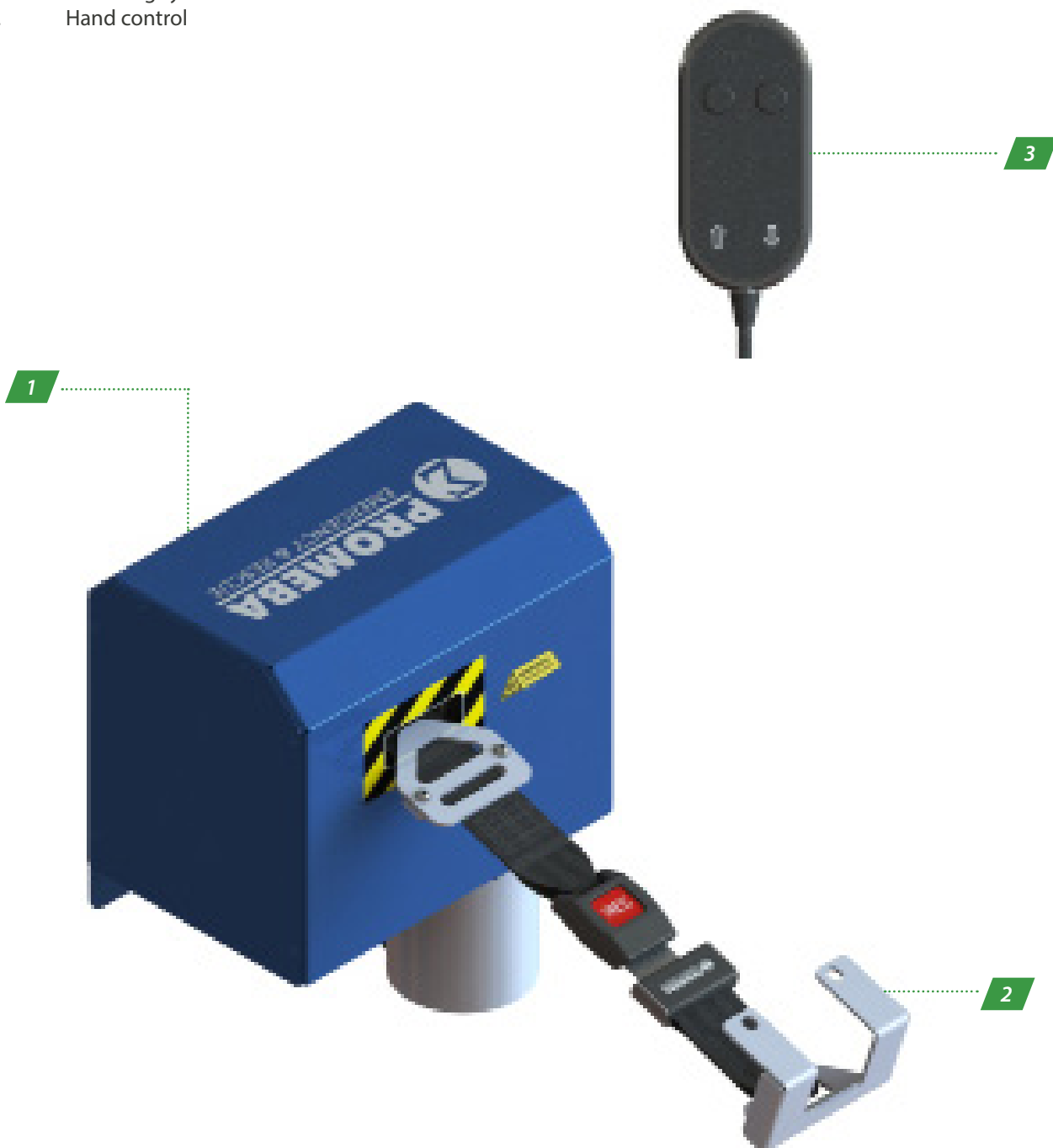

# 05 OPERATING

## 05.1.1 Protective cover

The cover protects the engine from dust, external moisture and any external impact.

For longer product durability, do not remove the cover.



## 05.1.2 Fastening system with belt

Anchoring and release of the fixing system:

1 - Insert the two parts as shown in left image, until it makes "CLICK".  
Make sure it is secured by pulling in the opposite direction as shown in right image.

2 - Press the red button to release the two parts and separate them in the direction indicated in the right image.



## 05.1.3 Hand control

Release and collection of the fixing system:

1 - Press the left button indicated in left image to roll up the belt and pull the load.

2 - Press the right button indicated in right image to unwrap the belt and release the load.

WARNING: if the belt is rolled up without any load, it has to be always manually guided during all the operation until it enters into the winch. This way it can be prevented hitting any person nearby or the bench itself.



# 06 MOUNTING AND COMPONENTS

## 06.1 Main exploded view of WINCH

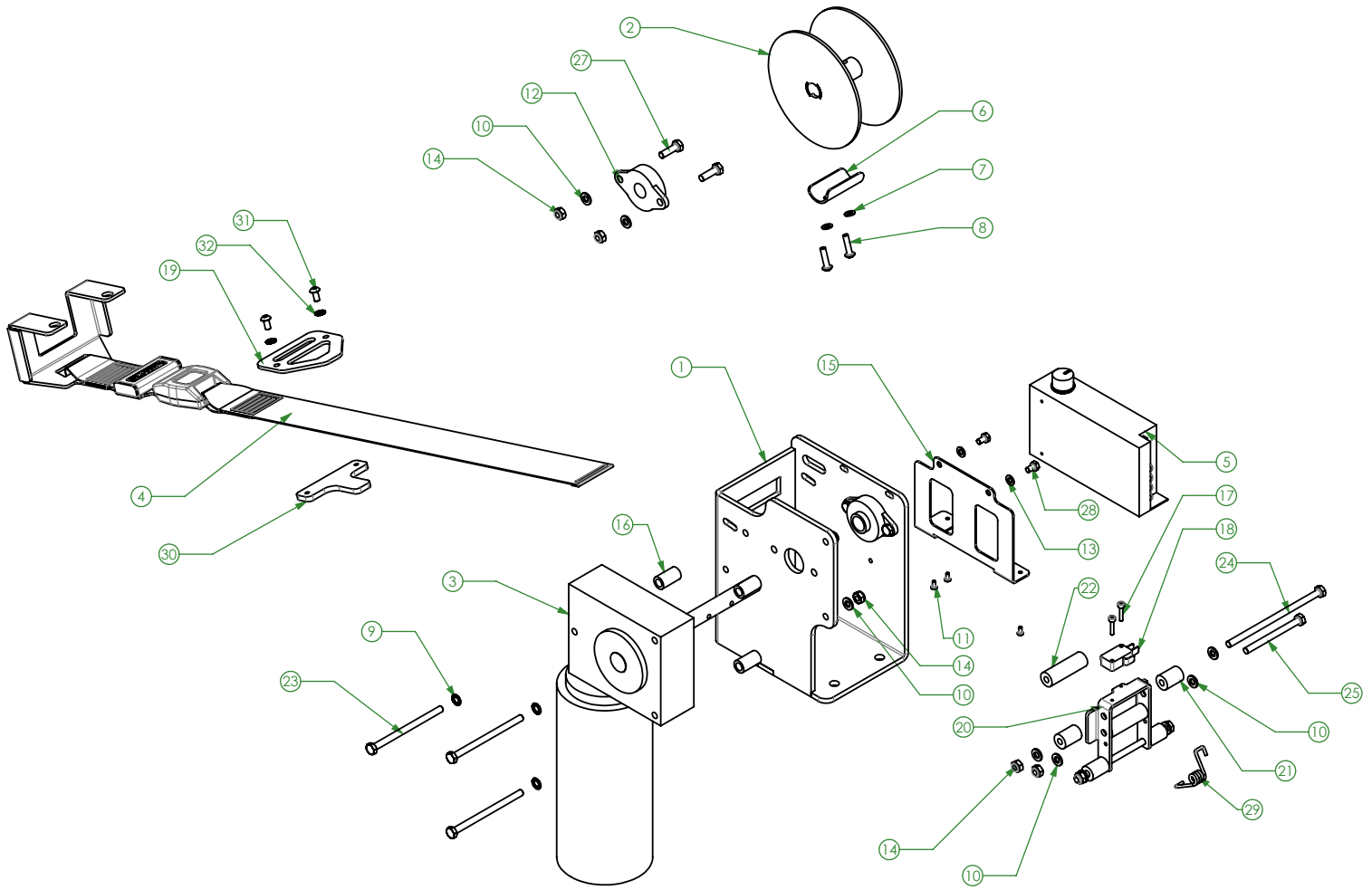



# 06 MOUNTING AND COMPONENTS

06.2 Bill of material

Main exploded view

WINCH

NUM. ELEMENT	CODE - DESCRIPTION	UNITS
1.01	PA4901-01001 - Subconjunt suport cabrestant seguretat basculant	1
1.02	PA4900-02011 - Subconjunt tambor	1
1.03	PA4900-00030 - Conjunt motor	1
1.04	PA4900-00080 - Conjunt cinturons cabrestant	1
1.05	PA4900-00050 - Caixa de control	1
1.06	PA4900-00021 - Apretador cinturo	1
1.07	31201051 - ARANDELA DIN-125 M5 CINCADA	2
1.08	3111305201 - TORNILLO DIN-7380 M5x20 CINCADO	2
1.09	31203061 - ARANDELA DIN-6798 M6 CINCADA	3
1.10	31201061 - ARANDELA DIN-125 M6 CINCADA	13
1.11	3111003061 - TORNILLO DIN-7985 M-3x6 CINCADO	3
1.12	PA4900-00150 - Rodament 15mm	2
1.13	31201051 - ARANDELA DIN-125 M5 CINCADA	2
1.14	31305061 - TUERCA DIN-985 M6 CINCADA	10
1.15	PA4901-00111 - Suport electronica	1
1.16	PA2700-00091 - Casquell tope obertura anclatge	3
1.17	3110203161 - TORNILLO DIN-912 M3x16 CINCADO	2
1.18	MICRO83160CR - Micro pulsador Highly VS10N00	1
1.19	PA4901-00040 - TOPALL CINTURONS	1
1.20	PA4901-01030 - Xapa rodets basculant	1
1.21	PA4901-01200 - DISTANCIADOR	4
1.22	PA4901-01100 - RODET CINTURO	2
1.23	3110406901 - TORNILLO DIN-933 M6x90 CINCADO	3
1.24	31104061201 - TORNILLO DIN-933 M6X120 CINCADO	2
1.25	3110406701 - TORNILLO DIN-933 M6x70 CINCADO	1
1.26	PA4900-00190 - Bossa components electricos cabrestant	1
1.27	3110406201 - TORNILLO DIN-933 M6x20 CINCADO	4
1.28	3110405081 - TORNILLO DIN-933 M5X8 CINCADO	2
1.29	PA4901-01050 - Molla retorn basculant	1
1.30	PA4901-00050 - XAPA ANTI-DESTENSAT	1
1.31	3111305101 - TORNILLO DIN-7380 M5X10 CINCADO	2
1.32	31203051 - ARANDELA DIN-6798 M5 CINCADA	2

# 06 MOUNTING AND COMPONENTS

## 06.3 Exploded view of electrical components, cover and screws

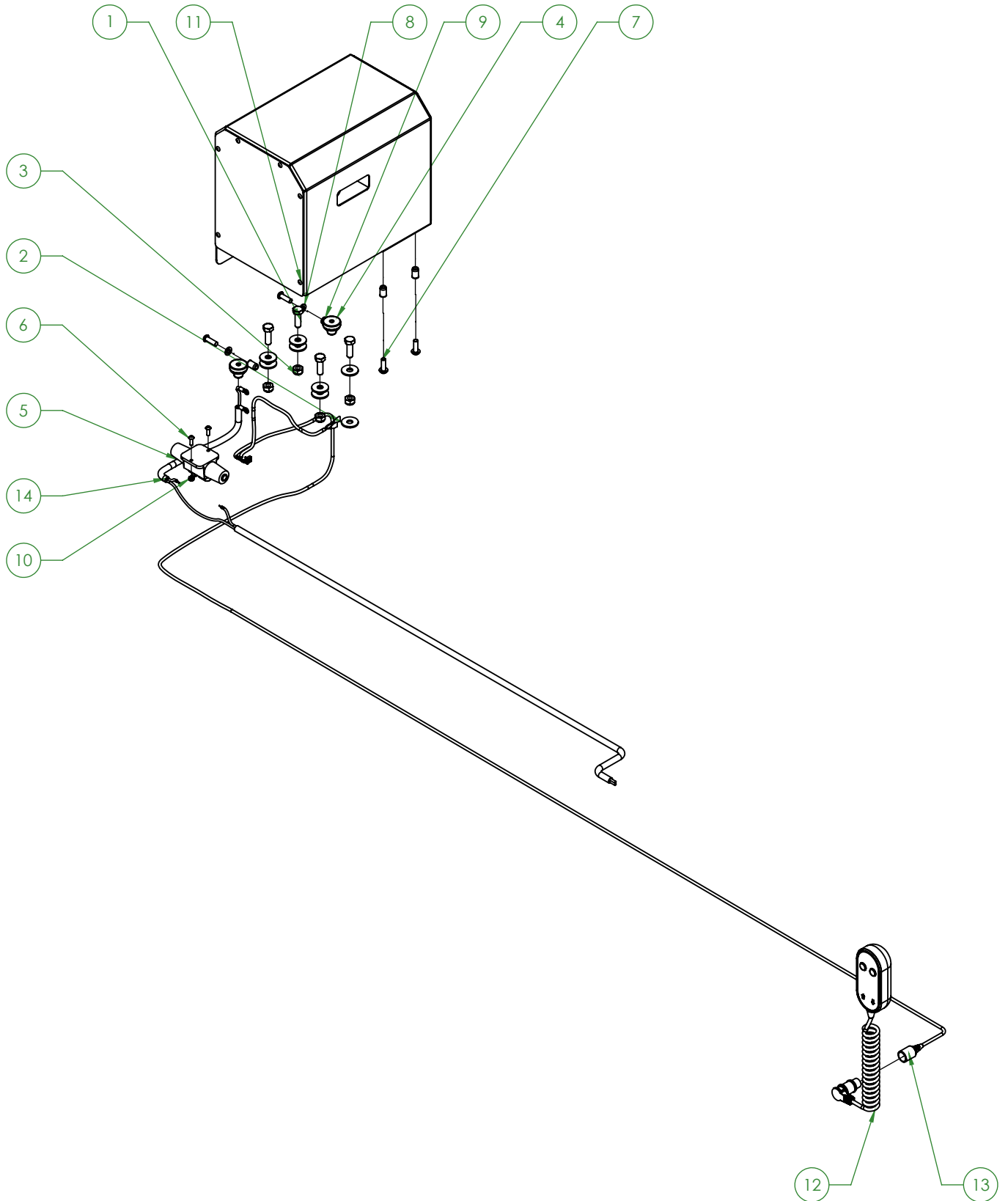





# 07 TROUBLESHOOTING

PROBLEM	CAUSE	SOLUTION
Winch is switched off	ON/OFF switch not pressed	Press the switch
	Vehicle battery drained	Charge or replace the battery
	2A fuse on current regulator blown	Fix the blowing cause and replace the fuse
	60A power fuse blown	Fix the blowing cause and replace the fuse
	Bad contact in connectors	Plug the connectors properly
Winch is switched on but doesn't work	Speed adjusting wheel not released while winch has been switched on	Release the wheel switch the winch off and then on again
	Low battery	Charge or replace the battery
	Damaged speed adjusting wheel	Replace the pendant control
	Damaged speed adjusting potentiometer	Replace the pendant control
	Bad contact in connectors	Plug the connectors properly
Working direction reversed	Webbing wrapped reversed	Make all the webbing unwrap and wrap it keeping the scroll wheel in the same direction
	Power wires reversed	Connect the two power wires reverse
Winch suddenly stops while wrapping	Inward limit reached	Unwrap the webbing
	Overload	Reduce the towed load
	Overheating	Switch the winch off for 30 minutes

## 08 GENERAL MAINTENANCE

### CLEANING

Keeping the equipment clean is essential to ensure good use and durability of the assembly. It is necessary to perform a thorough cleaning periodically, especially in areas exposed to dirt that can suffer damage such as gears, connectors, buttons, etc. Do not use high pressure washers, they may damage the electrical elements.

### CONTROLS AND SELECTORS

Due to the intense and continuous use of the movable elements, as the controls and selectors, periodically check the proper functioning of the same. There may be faults in the micro-breakers and wiring, check the fixings and electrical or mechanical connections that may exist.

### OIL

In general, any moving part must be oiled. Our products come from the factory completely oiled and lubricated, however, it is possible that with the time and use of the product the elements are decreased, either by loss of lubrication or by dirt. Clean and grease periodically affected areas, according to manufacturer's specifications.

Check for loose, missing, or worn parts. Periodically inspect all moving parts to make sure components are tight.

Due to its dry slip system, do not grease the platform guide.

**ATTENTION:** Do not lubricate the rail and / or stretcher when connected to the mains.



### WEARING AREAS

Inspecting regularly to see if there is wear on the system components is a preventive measure that can reduce breakdowns. Check for possible lubricant leaks, grooves or bearings in poor condition.

### MECHANICAL FASTENING ELEMENTS

In general, we call mechanical fastening elements for the components that are used to fix the whole of the product, mainly fasteners and derivatives.

In some conditions of use, due to vibrations and impacts, certain elements can lose their tightening torque or fixing properties.

Check periodically that there are no loose elements, especially in moving parts of the assembly. Always observe the recommended tightening torques.

### REPLACEMENT OF COMPONENTS

This instruction manual does not include procedures for all parts. Typically, qualified service personnel replace wires, switches and certain mechanical parts without the need for step-by-step procedures.

Qualified service personnel should contact our sales department for information on ordering parts and installing them.



MAKE SURE THAT NO WATER ENTERS THE ENGINE AND THAT IT IS IN GOOD CONDITION.

## 09 LEGAL NOTICES

This document may contain technical inaccuracies or typographical errors.

Periodic changes are made to the information contained herein; These changes will be incorporated in new editions of the publication.

**Promeba, S.L.** Reserves the right to make any changes or improvements to the products described in this publication, if deemed appropriate.

**Promeba, S.L.** May have patents or pending patent applications addressing issues described in this document. The possession of this document does not confer any license on said patents.

The information contained in this document does not affect or change the specifications or warranties of the product **Promeba, S.L.**

No part of this document shall be construed as an express or implied license or indemnification under the intellectual property rights of **Promeba, S.L.** Or third parties.

All information contained in this document has been obtained in specific environments and is presented as an illustration. Results obtained in other operating environments may vary.

**Promeba, S.L.** may use or distribute the information provided by the customer in a way that creates timely, without incurring any obligation with the client.





# 10 PRODUCT WARRANTY

**Promeba, S.L.** ensures that your products have passed satisfactorily all the established quality controls, both functional and material. The duration of the warranty is 2 years from the date of purchase of the product.

This warranty is valid only when it is presented with the original invoice or proof of purchase (indicating the date of purchase, model and dealer name) together with the defective product during the period covered by the warranty. **Promeba, S.L.** reserves the right not to offer the free warranty service if the indicated documents are not presented or if the information they contain is incomplete or illegible.

*1. This warranty does not apply if the model name or serial number of the product has been altered, deleted, disappeared or is unreadable.*

*2. This warranty does not cover transport costs or the risks associated with transporting your product to and from **Promeba, S.L.***

*3. This warranty does not cover any of the following:*

*a) Periodic maintenance and repair or replacement of parts derived from normal wear and tear.*

*b) Periodic maintenance and repair or replacement of consumables (components that are expected to require periodic replacement during the life of the product, such as non-rechargeable batteries, bulbs, etc.). Parts from normal wear and tear...*

*c) Damage or defects arising from improper use, operation or treatment of the product and not from normal use of the product.*

*d) Damage arising from:*

i. Misuse, including:

- Treatment resulting in damage or changes in the physical, surface or appearance of the product.

- Installation, use or storage of the product in a manner that does not comply with the instructions described by **Promeba, S.L.**

- Maintenance of the product in a manner that does not comply with the instructions of **Promeba, S.L.** for proper maintenance.

- Installation or use of the product in a manner that does not respect the technical or safety standards of the country where it is used or installed.

ii. Use of components not provided with the product or improper installation of accessory parts not previously tested.

iii. States or defects of the system in which the product is used or incorporated with the exception of other products **Promeba, S.L.** designed for use with the product.

iv. Use of the product with accessories, peripheral units and other products of a type, condition or standards not established by **Promeba, S.L.**

v. The manufacturer or distributor will be solely responsible for deciding the shipment of the parts for repair, or replacement of the product in its entirety. In no case will workers be sent for such repair or replacement of the product.

Except in the cases mentioned above, **Promeba, S.L.** shall not give any warranties with respect to the product, performance, accuracy, reliability or adaptability to a purpose of the logical or other equipment. If this exception is not lawful or contemplated by the current law, **Promeba, S.L.** limit or exclude its warranties only to the extent permitted by law.

The only obligation on the part of **Promeba, S.L.** in connection with this warranty is to repair or replace the parts subject to the terms and conditions of this warranty.

**Promeba, S.L.** is not responsible for the loss or damage of products, this warranty or others, including economic loss or non-evaluable damages; The price paid for the product; Loss of profits, income, information, usufruct or use of the product or associated products or indirect, accidental or critical loss or damage.

This clause refers to whether the loss or damage is due to deterioration or inoperability of the associated product due to defects or unavailability of **Promeba, S.L.**, which has caused a downtime, loss of user time or a business interruption.

In cases where the law prohibits or limits these exclusions of liability, **Promeba, S.L.** exclude or limit its liability only to the extent permitted by applicable law. For example, there are countries that prohibit the exclusion or limitation of damages caused by negligence, reckless negligence, willful misconduct, fraud, and similar acts. The responsibility of **Promeba, S.L.** in this warranty will not exceed, in any case, the price paid for the product, but if the current law allows only limitations of greater responsibilities, these will apply.

# 11 TRAINING REGISTER

PLACE AND DATE	NAME OF THE OPERATOR	NAME OF TRAINER	TYPE OF TRAINING

# 12 MAINTENANCE REGISTER

DATE	TYPE OF SERVICE (Maintenance / verification / extension of useful life)	OPERATIONS OF MAINTENANCE REALIZED	PERSON IN CHARGE OF SERVICE (Operator / Center Authorized / Manufacturer)



Todos los derechos reservados. Reservado el derecho ha modificaciones sin previo aviso.  
Promeba, S.L. no se considera responsable de los daños causados por la falta o la inexactitud de la información aquí mencionada.

*All rights reserved. Variations can be done whitout notice.  
Promeba, S.L. is to be considered not responsible for damages caused by the lack or the wrongness of the information here mentioned.*



PROMEBA, S.L.

Ctra C-16 Km 59,5 · 08650 Sallent (Barcelona) · SPAIN  
T. 93 837 12 00 · Fax 93 820 61 08  
promeba@promeba.com · www.promeba.com